

# 2' x 4' AC Back-light Troffer - 5000K



## Product Description

The 2' x 4' AC Backlight Troffer is a recessed LED Luminaire for use within a ceiling grid for general lighting or as an interior architectural backlight for image illumination. It's versatile design allows it to be installed in multiple configurations and can be customized to any shape.

Electrical				
	Minimum	Typical	Maximum	Units
Input Voltage	120	-	277	Vac
Input Current	-	0.95	-	A
Input Power	-	115	-	W
Heat	-	392	-	BTU/hr

Mechanical				
	Minimum	Typical	Maximum	Units
Dimensions	-	47 3/4 x 23	-	in
Electrical Connection	-	Junction/Whip	-	-
Fixture Weight	-	-	10	lbs

Compliance				
	Minimum	Typical	Maximum	Units
Regulatory Safety	-	Listed	-	UL 1598 CSA C22.2#250.0
CE	-	Pending	-	
RoHS	-	Pending	-	2011/65/EU

Environmental				
	Minimum	Typical	Maximum	Units
Storage Temperature	-40	25	85	C
Operating Temperature	-20	25	35	C
Humidity	5	-	95	%
Warranty	3	-	-	Years

**Installation Notes**  
Additional support locations may be required to support an average fixture weight of 4lbs/sqft

## Mechanical Dimensions

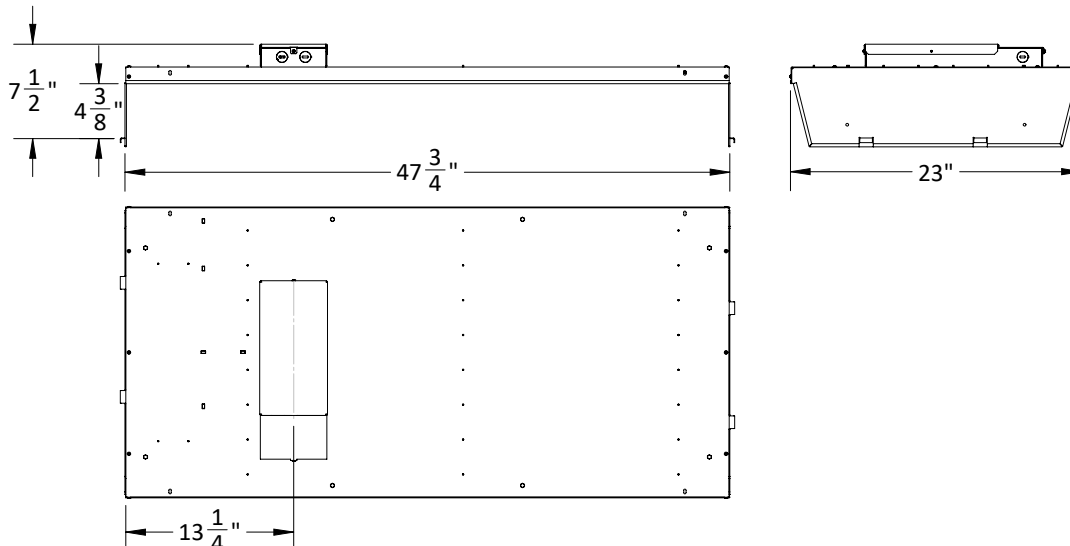

1-07-000111

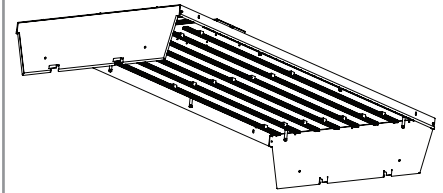

\*Custom sizes available. Check with Sentient for Custom Sizes and Photometric Performance.



700 Walnut Ridge Drive  
Hartland, WI 53029  
Phone: 262-367-7700  
Web: www.pdcbiz.com  
Email: pdcbiz@pdcbiz.com



© 2019 PDC Facilities, Inc. All rights reserved.  
For informational purposes only. Content is subject to change.

Date Revised: 2019.06.21